



GICOB™ range of API 6D and BS standard valves are stringently tested for the best in quality and delivery to our customers. Our products are manufactured using the latest technology and strictly coherent with client's expectation.

Our mission is to provide the right solution with exceptional quality valves.

All Material used by GICOB™ comply with the pre-qualified material identified in NACE MR0175/ISO 15156. Body material ranging from Carbon steel, Stainless steel to low temperature steel.

PRODUCT DETAILS: -

GICOB™ GB Model: Cast Series Trunnion Ball Valve Design

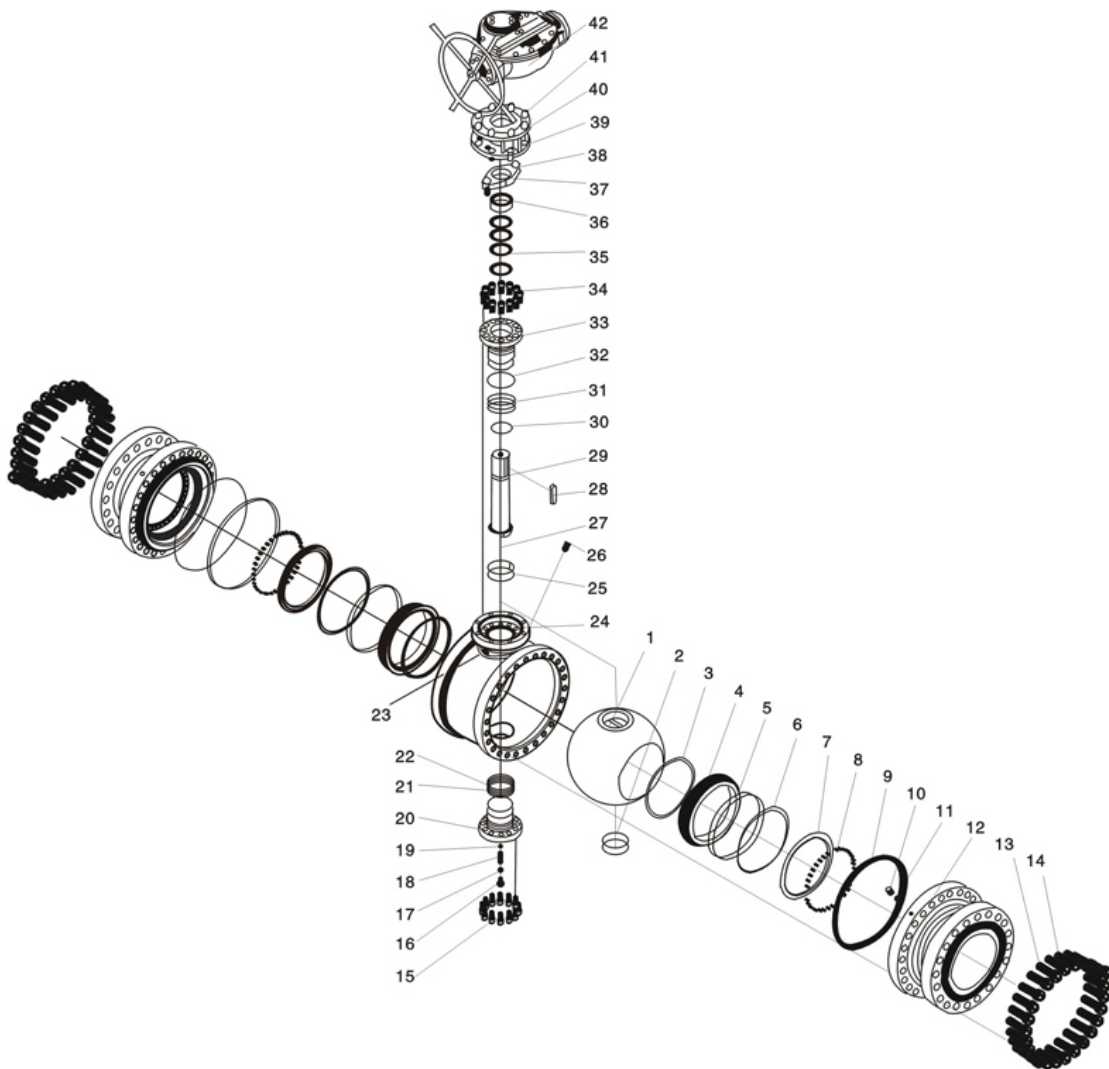

GICOB™ GB Model: Cast Series Trunnion Ball Valve Part List

Item	Description	Valve Material			
		Carbon Steel	Stainless Steel	Low Temp Steel	NACE Standard
1	Ball	A105+HCr/ENP	A351 CF8, CF8M, CF3, CF3M	A352 LCB, LCC+ENP	A351 CF8M+ENP
2	Bush Bearing	Metal + PTFE, Braided Graphite Fibre			
3	Sealing Ring	NYLON, MOLON, DELRIN, PEEK			
4	Seat	A105+HCr/ENP	A182 F304, 316	A182 F6A	A182 F316
5	O Ring	VITON			
6	Gasket	Soft Graphite+SS			
7	Supporting Ring	A105+HCr/ENP	A182 F304, 316	A182 F6A	A182 F316
8	Spring	INCONEL X750			
9	O Ring	VITON			
10	Sealant Injection Valve	A216 WCB	A351, CF8, CF8M, CF3, CF3M	A352 LCB, LCC	A351 CF8M
11	Gasket	Soft Graphite+SS			
12	Bonnet	A216 WCB	A351, CF8, CF8M, CF3, CF3M	A352 LCB, LCC	A351 CF8M
13	Stud	193 B7	A193 B8, B8M	A320 L7	A193 B7M
14	Nut	A194 2H	A194 8M	A194 4	A194 2HM
15	Nipple	A193 B7	A193 B8, B8M	A320 L7	A193 B7M
16	Plug	A29 1025	SS	SS	SS
17	Gasket	RPTFE			
18	Nipple	A193 B7	A193 B8, B8M	A320 L7	A193 B7M
19	Ball	A105+HCr/ENP	A182 F304		
20	Bottom Cover	A105+HCr/ENP	A182 F304, 316	A29 4140+ENP	A105+A182 F316, HCr/ENP
21	Gasket	Soft Graphite+SS			
22	O Ring	VITON			
23	Sealant Injection Valve	A216 WCB	A351, CF8, CF8M, CF3, CF3M	A352 LCB, LCC	A351 CF8M
24	Body	A216 WCB	A351, CF8, CF8M, CF3, CF3M	A352 LCB, LCC	A351 CF8M
25	Bush Bearing	Metal+PTFE, Braided Graphite Fibre			
26	Drainage Valves	A216 WCB	A351, CF8, CF8M, CF3, CF3M	A352 LCB, LCC	A351 CF8M
27	Spring	A276 304			
28	Key	SS			
29	Stem	A29 4140+ENP	A182 F304, 316	A182 F6A	A182 F304
30	Thrust Bearing	Metal+PTFE, Braided Graphite Fibre			
31	O Ring	VITON			
32	Gasket	Soft Graphite+SS			
33	Cover	A105+HCr/ENP	A182 F304, 316	A182 F6A	A182 F316
34	Screw	A193 B7	A193 B8, B8M	A320 L7	A193 B7M
35	Packing	Soft Graphite, PTFE			
36	Packing Gland	A182 F6A	A182 F304, 316	A182 F304	A182 F316
37	Gland Flange	A216 WCB	A351 CF8, CF8M	A351 CF8	A351 CF8M
38	Bolt	A193 B7	A193 B8, B8M	A320 L7	A193 B7M
39	Bolt	A193 B7	A193 B8, B8M	A320 L7	A193 B7M
40	Yoke	A216 WCB	A351 CF8	A352 LCB	A351 CF8
41	Bolt	A193 B7	A193 B8, B8M	A320 L7	A193 B7M

GICOB™ GB Model: Forge Series Trunnion Ball Valve Design

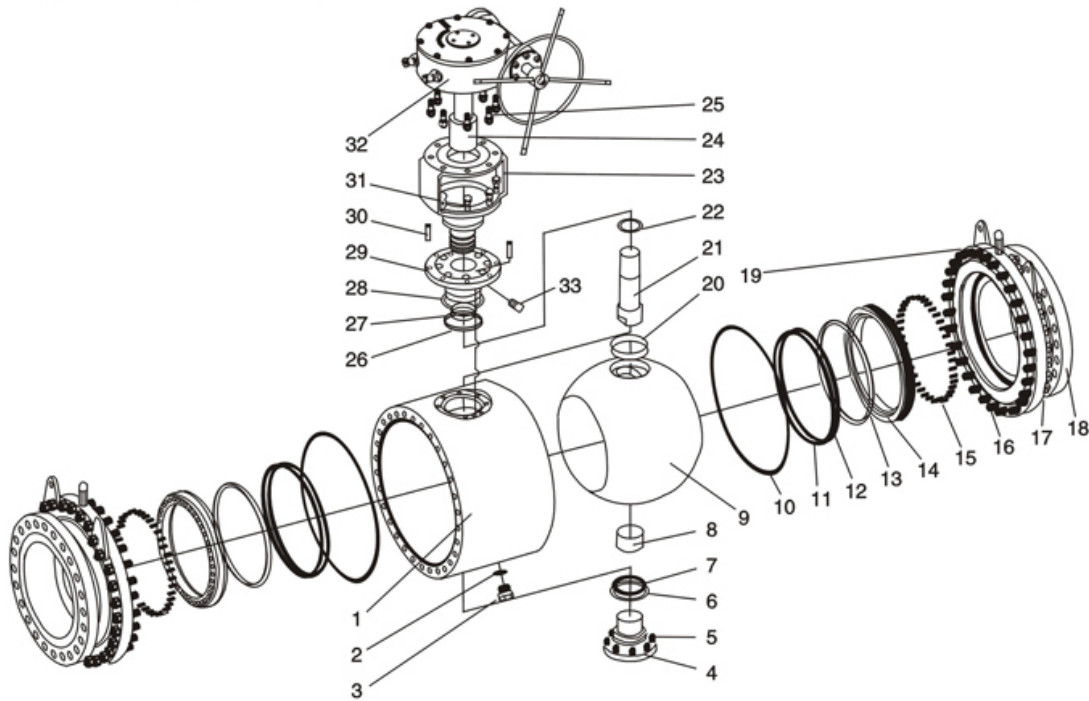

GICOB™ GB Model: Forge Series Trunnion Ball Valve Part List

Item	Description	Material		
		Carbon Steel	Stainless Steel	Low Temp Steel
1	Body	A105	A182 F304	A350 LF2
2	Gasket		Soft Graphite+SS	
3	Drain Valve	A29 1025	A182 F304	SS
4	Bottom Cover	A105	A182 F304	A350 LF2
5	Stud	A193 B7	A193 B8	A320 L7
6	Gasket		Soft Graphite+SS	
7	O Ring		VITON	
8	Bush Bearing	PTFE+CS	PTFE+SS	PTFE+SS
9	Ball	A105+ENP	A182 F304	A182 F304
10	Flange Gasket		Soft Graphite	
11	O Ring		VITON	
12	Gasket		Soft Graphite+SS	
13	Seals		PTFE, NYLON, PEEK, MOLON, PCTFE	
14	Seat	A105+ENP	A182 F304	F182 F304
15	Spring		INCONELX750	
16	Stud	A193 B7	193 B8	A320 L7
17	Nut	A194 2H	A194 8	A194 7
18	Bonnet	A105	A182 F304	A350 LF2
19	Sealant Injection Valve	A209 1025	SS	SS
20	Bush Bearing	PTFE+CS	PTFE+SS	PTFE+SS
21	Stem	A182 F6A	A182 F304	A182 F304
22	Flat Bush Bearing	PTFE+CS	PTFE+SS	PTFE+SS
23	Yoke		A216 WCB	
24	Connecting Ring		ANSI 1025	
25	Stud		A193 B7	
26	O Ring		VITON	
27	O Ring		VITON	
28	Gasket		Soft Graphite+SS	
29	Cover	A105	A182 F304	A350 LF2
30	Locating Pin		A182 F6A	
31	Stud		A193 B7	
32	Worm Gear		A216 WCB	
33	Sealant Injection Valve	A29 1025	SS	SS

Full Bore Trunnion Ball Valve Dimensions & Weights (150#, 300#, 600#, 900#)

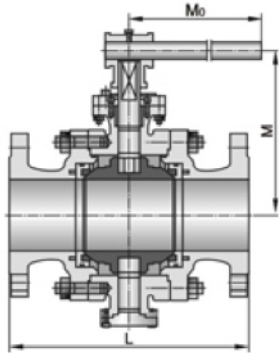

Lever Operated

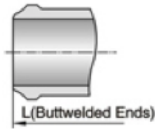

Butt Weld Connection

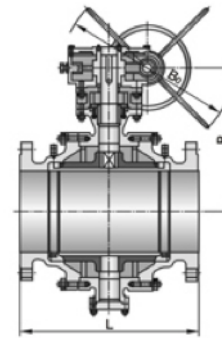

Worm Gear Operated

NPS (in)	Class 150										Class 300										mm
	L			d	Lever		Worm Gear/ Handwheel		Wt. RF (kg)	L			d	Lever		Worm Gear/ Handwheel		Wt. RF (kg)			
	RF	BW	RTJ		M	M ₀	B	B ₀		RF	BW	RTJ		M	M ₀	B	B ₀				
2	178	216	191	49	107	230	-	-	12	216	216	232	49	107	230	-	-	15			
3	203	283	216	74	152	400	-	-	22	283	283	298	74	152	400	-	-	30			
4	229	305	241	100	176	650	-	-	35	305	305	321	100	178	650	-	-	55			
5	356	381	-	125	252	1050	-	-	58	381	381	-	125	252	1050	-	-	87			
6	394	457	406	150	272	1050	378	400	74	403	403	419	150	272	1050	378	400	118			
8	457	521	470	201	-	-	421	400	205	502	502	518	201	-	-	421	400	255			
10	533	559	546	252	-	-	482	400	322	568	568	584	252	-	-	482	600	370			
12	610	635	622	303	-	-	549	600	460	648	648	664	303	-	-	549	600	533			
14	686	762	699	334	-	-	582	600	576	762	762	778	334	-	-	582	800	640			
16	762	838	775	385	-	-	687	800	864	838	838	854	385	-	-	687	800	1030			
18	864	914	876	436	-	-	730	800	1280	914	914	930	436	-	-	730	800	1542			
20	914	991	927	487	-	-	772	800	1600	991	991	1010	487	-	-	772	800	2100			
24	1067	1143	1080	589	-	-	995	800	3540	1143	1143	1165	589	-	-	995	800	3430			
26	1143	1245	-	633	-	-	1022	800	3930	1245	1245	1270	633	-	-	1022	800	4340			
28	1245	1346	-	684	-	-	1088	800	4500	1346	1346	1372	684	-	-	1088	800	4960			
30	1295	1397	-	735	-	-	1153	800	5370	1397	1397	1422	735	-	-	1153	800	5950			
32	1372	1524	-	779	-	-	1223	800	5940	1524	1524	1553	779	-	-	1223	800	6760			
34	1473	1626	-	830	-	-	1307	800	6615	1626	1626	1654	830	-	-	1307	800	8280			
36	1524	1727	-	874	-	-	1374	800	7540	1727	1727	1756	874	-	-	1374	960	9640			
40	1753	1956	-	976	-	-	1468	960	9320	1930	1930	-	976	-	-	1468	960	11730			
42	1855	2083	-	1020	-	-	1532	960	14450	2032	2032	-	1020	-	-	1532	960	16300			
48	2134	2388	-	1166	-	-	1670	960	19200	2388	2388	-	1166	-	-	1670	960	20160			
54	-	-	-	1312	-	-	1858	960	-	-	-	-	1312	-	-	1858	960	-			
56	2388	2388	-	1360	-	-	1920	960	29400	2642	2642	-	1360	-	-	1920	960	30860			
60	2540	2540	-	1458	-	-	2070	960	36000	2946	2946	-	1458	-	-	2070	960	37800			
NPS (in)	Class 600										Class 900										
	L			d	Lever		Worm Gear/ Handwheel		v	L			d	Lever		Worm Gear/ Handwheel		Wt. RF (kg)			
	RF	BW	RTJ		M	M ₀	B	B ₀		RF	BW	RTJ		M	M ₀	B	B ₀				
2	292	292	295	49	107	400	-	-	35	368	368	371	49	123	650	-	-	50			
3	356	356	359	74	152	650	-	-	38	381	381	384	74	-	-	185	400	92			
4	432	432	435	100	178	1050	-	-	55	457	457	460	100	-	-	225	400	146			
5	508	508	-	125	-	-	-	-	102	-	-	-	-	-	-	-	-	-			
6	559	559	562	150	-	-	389	400	160	610	610	613	150	-	-	389	600	339			
8	660	660	664	201	-	-	449	600	232	737	737	740	201	-	-	449	600	640			
10	787	787	791	252	-	-	497	600	390	838	838	841	252	-	-	497	800	960			
12	838	838	841	303	-	-	550	800	710	965	965	968	303	-	-	550	800	1330			
14	889	889	892	334	-	-	582	800	960	1029	1029	1038	322	-	-	582	800	1640			
16	991	991	994	385	-	-	687	800	1700	1130	1130	1140	373	-	-	687	800	2240			
18	1092	1092	1095	436	-	-	730	800	1970	1219	1219	1232	423	-	-	730	800	2770			
20	1194	1194	1200	487	-	-	780	800	2180	1321	1321	1334	471	-	-	780	800	3740			
24	1397	1397	1407	589	-	-	995	800	3250	1549	1549	1568	570	-	-	995	800	5560			
26	1448	1448	1461	633	-	-	1038	800	4880	1651	1651	1674	617	-	-	1038	800	7070			
28	1549	1549	1562	684	-	-	1088	800	5830	1753	1753	1775	665	-	-	1088	800	8070			
30	1651	1651	1664	735	-	-	1157	800	6700	1880	1880	1902	712	-	-	1157	800	9680			
32	1778	1778	1794	119	-	-	1190	800	7450	2032	2032	2054	760	-	-	1190	960	11000			
34	1930	1930	1946	830	-	-	1246	960	8470	2159	2159	2188	808	-	-	1246	960	13470			
36	2083	2083	2099	874	-	-	1292	960	10360	2286	2286	2315	855	-	-	1292	960	15700			
40	2337	2337	-	976	-	-	1361	960	12080	2410	2410	2438	959	-	-	1361	960	20040			
42	2387	2387	-	1020	-	-	1423	960	15420	2515	2515	2540	1003	-	-	1423	960	23620			
48	2540	2540	-	1166	-	-	1568	960	25260	2620	2620	-	1155	-	-	1568	960	32830			
54	-	-	-	1312	-	-	1680	960	-	-	-	-	-	-	-	1680	960	-			
56	2667	2667	-	360	-	-	1730	960	38670	2820	2820	-	1337	-	-	1730	960	44086			
60	2950	2950	-	1458	-	-	1866	960	47360	2930	2930	-	1438	-	-	1866	960	55210			

Full Bore Trunnion Ball Valve Dimensions & Weights (1500#, 2500#)

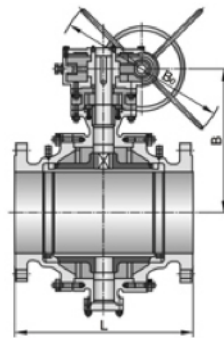

Worm Gear Operated

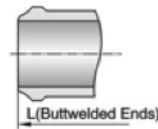

Butt Weld Connection

NPS (in)	Class 1500							Class 2500							mm
	L			d	Worm Gear/ Handwheel		Wt. RF (kg)	L			d	Worm Gear/ Handwheel		Wt. RF (kg)	
	RF	BW	RTJ		B	B ₀		RF	BW	RTJ		B	B ₀		
2	368	368	371	49	154	400	50	451	451	454	42	174	600	93	
3	470	470	473	74	187	600	117	578	578	584	62	224	800	215	
4	546	546	549	100	217	600	216	673	673	683	87	268	800	385	
5	-	-	-	-	-	-	-	-	-	-	-	-	-	-	
6	705	705	711	144	346	800	532	914	914	927	131	371	800	830	
8	832	832	841	192	384	800	870	1022	1022	1038	179	420	800	1435	
10	991	991	1000	239	452	800	1467	1270	1270	1292	223	540	800	2220	
12	1130	1130	1146	287	512	800	2270	1422	1422	1445	241	638	800	3050	
14	1257	1257	1276	315	561	800	3240	1540	1540	1569	265	663	800	3350	
16	1384	1384	1407	360	601	800	4645	1567	1567	1596	276	764	800	5375	
18	1537	1537	1559	371	688	800	6035	1825	1825	1854	311	847	800	5800	
20	1664	1664	1686	416	727	800	8077	1875	1875	1904	343	867	800	8612	
24	1943	1943	1972	498	803	800	12357	2257	2257	2286	413	1060	960	12747	
26	2048	2048	2099	540	853	800	14179	-	-	-	-	-	-	-	
28	2148	2148	2176	584	938	960	16314	-	-	-	-	-	-	-	
30	2251	2251	2281	625	1070	960	19466	-	-	-	-	-	-	-	
32	2346	2346	2380	670	1200	960	25728	-	-	-	-	-	-	-	
34	2450	2450	2454	720	1310	960	31416	-	-	-	-	-	-	-	
36	2556	2556	2590	762	1430	960	30478	-	-	-	-	-	-	-	

**Reduced Bore Trunnion Ball Valve Dimensions & Weights
(150#, 300#, 600#, 900#, 1500#, 2500#)**

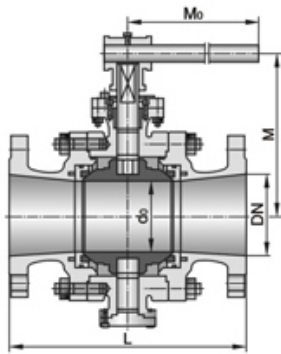

Lever Operated

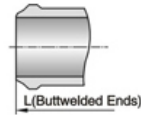

Butt Weld Connection

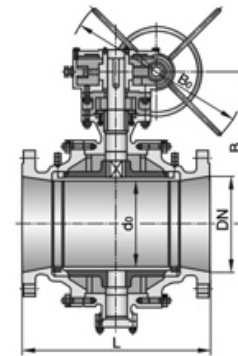

Worm Gear Operated

mm

NPS DN x d _o (in)	Class 150									Class 300								
	L			d	Lever		Worm Gear/ Handwheel		Wt. RF (kg)	L			d	Lever		Worm Gear/ Handwheel		Wt. RF (kg)
	RF	BW	RTJ		M	M _o	B	B _o		RF	BW	RTJ		M	M _o	B	B _o	
3x2	203	283	216	49	107	230	-	-	19	283	283	298	49	107	230	-	-	28
4x3	229	305	241	74	152	400	-	-	32	305	305	321	74	152	400	-	-	38
6x4	394	457	406	100	178	650	-	-	55	403	403	419	100	178	650	-	-	67
8x6	457	521	470	150	272	1050	378	400	73	502	521	517	150	282	1050	378	400	95
10x8	533	559	546	201	-	-	421	400	122	568	559	584	201	-	-	421	400	144
12x10	610	635	622	252	-	-	482	400	310	648	635	664	252	-	-	482	400	380
14x12	686	762	699	303	-	-	549	600	470	762	762	778	303	-	-	549	600	580
16x14	762	838	775	336	-	-	607	600	590	838	838	854	336	-	-	607	700	780
18x16	864	914	876	385	-	-	687	800	830	914	914	930	385	-	-	687	800	1190
20x18	914	991	927	435	-	-	713	800	1040	991	991	1010	435	-	-	713	800	1880
24x20	1067	1143	1080	487	-	-	772	800	1650	1143	1143	1164	487	-	-	772	800	2750
30x24	1295	1397	-	589	-	-	995	800	4100	1397	1397	1422	587	-	-	995	800	4810
36x30	1524	1727	-	735	-	-	1153	800	6450	1727	1727	1756	735	-	-	1153	800	8440
NPS DN x d _o (in)	Class 600									Class 900								
	L			d	Lever		Worm Gear/ Handwheel		Wt. RF (kg)	L			d	Lever		Worm Gear/ Handwheel		Wt. RF (kg)
	RF	BW	RTJ		M	M _o	B	B _o		RF	BW	RTJ		M	M _o	B	B _o	
3x2	356	356	359	49	107	400	-	-	44	381	381	384	49	123	650	-	-	58
4x3	432	432	435	74	152	650	-	-	89	457	457	460	74	-	-	185	400	105
6x4	559	559	562	100	178	1050	-	-	160	610	610	613	100	-	-	225	400	230
8x6	660	660	664	150	-	-	389	400	310	737	737	740	150	-	-	389	600	470
10x8	787	787	791	201	-	-	449	600	570	838	838	841	201	-	-	449	600	530
12x10	838	838	841	252	-	-	497	600	850	965	965	968	252	-	-	497	800	1200
14x12	889	889	892	303	-	-	550	800	1180	1029	1029	1038	303	-	-	550	800	1695
16x14	991	991	994	303	-	-	550	800	1390	1130	1130	1140	303	-	-	550	800	1790
18x16	1092	1092	1095	385	-	-	387	800	1765	1219	1219	1232	373	-	-	687	800	2520
20x18	1194	1194	1200	385	-	-	387	800	2170	1321	1321	1334	471	-	-	687	800	2970
24x20	1397	1397	1407	487	-	-	780	800	3390	1549	1549	1568	570	-	-	780	800	5580
30x24	1651	1651	1664	589	-	-	995	800	5910	1880	1880	1902	570	-	-	995	800	8980
36x30	2083	2083	2099	735	-	-	1157	800	10560	2286	2286	2315	712	-	-	1157	800	15650
NPS DN x d _o (in)	Class 1500									Class 2500								
	L			d	Lever		Worm Gear/ Handwheel		Wt. RF (kg)	L			d	Lever		Worm Gear/ Handwheel		Wt. RF (kg)
	RF	BW	RTJ		M	M _o	B	B _o		RF	BW	RTJ		M	M _o	B	B _o	
3x2	470	470	473	49	-	-	154	400	75	578	578	584	42	-	-	174	600	165
4x3	546	546	549	74	-	-	187	600	130	673	673	683	62	-	-	224	800	280
6x4	705	705	711	100	-	-	217	600	300	914	914	927	87	-	-	268	800	540
8x6	832	832	841	144	-	-	346	800	615	1022	1022	1038	131	-	-	371	800	990
10x8	991	991	1000	192	-	-	384	800	1085	1270	1270	1292	179	-	-	420	800	1750
12x10	1130	1130	1146	239	-	-	452	800	1850	1422	1422	1445	223	-	-	540	800	2650
14x12	1257	1257	1276	287	-	-	512	800	2620	1540	1540	1569	265	-	-	638	800	4610
16x14	1384	1384	1407	287	-	-	512	800	2890	1567	1567	1596	265	-	-	638	800	4145
18x16	1537	1537	1559	360	-	-	601	800	3856	1825	1825	1854	276	-	-	764	800	7395
20x18	1664	1664	1686	360	-	-	601	800	5005	1875	1875	1904	276	-	-	764	800	8900
24x20	1943	1943	1972	416	-	-	727	800	11377	2257	2257	2286	343	-	-	867	800	12190
30x24	2251	2251	2281	498	-	-	803	800	17914	-	-	-	-	-	-	-	-	-
36x30	2556	2556	2590	625	-	-	1070	800	32976	-	-	-	-	-	-	-	-	-